

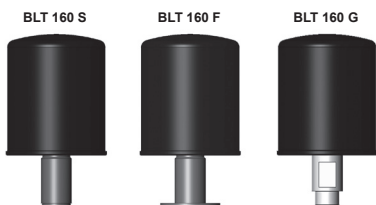

## Spare Parts List

### Air filter and dryer BLT

Up to 270 l/min



## 1. MAINTENANCE

### 1.1 GENERAL

Please follow the maintenance instructions!

### 1.2 COMMISSIONING

Check that the correct filter cartridge is fitted.

### 1.3 TOOLS REQUIRED FOR MAINTENANCE

Size	Tools
160	Strap wrench

## 2. CHANGING THE ELEMENT

### 2.1 CHANGING THE ELEMENT BLT

1. Unscrew filter cartridge anticlockwise using a strap wrench
2. Screw on new filter cartridge

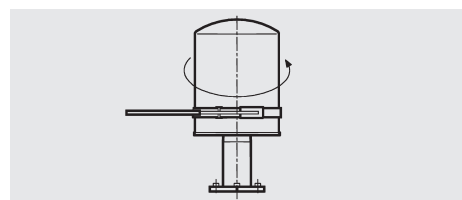

## 3. SPARE PARTS

### 3.1 SPARE PARTS DRAWING BLT

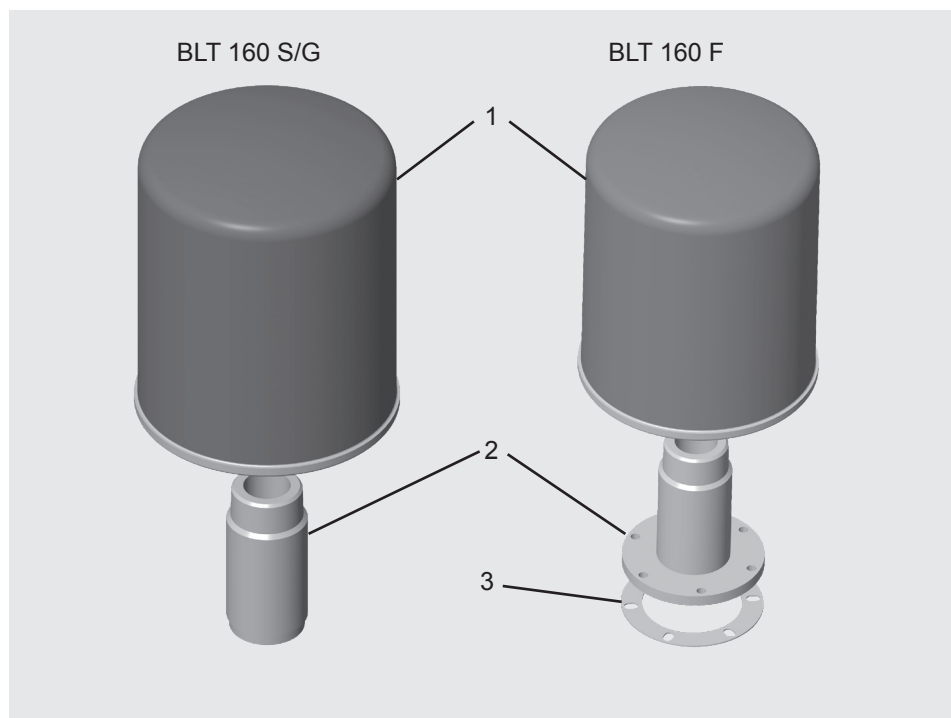

### 3.2 SPARE PARTS LIST BLT

Item	Description	160
1.	0160 MU 003 M	01265765
2.	Socket E BLT..160 S	01270587
	Socket E BLT..160 G	01300490
	Socket E BLT..160 F	01270588
3.	Seal kit-E	01271972

Other spare parts on request

## 4. REPLACEMENT ELEMENT

0160 MU 003 M

### Size

0160

### Version

MU

### Filtration rating

003 3 µm absolute

### Filter material

M molecular sieve

## 5. MAINTENANCE INSTRUCTIONS

### 5.1 USER INSTRUCTIONS FOR FILTERS



Notice

**It is the responsibility of the owner to comply with the water regulations of the country concerned.**



Caution

**Statutory accident prevention regulations, safety regulations and safety data sheets for fluids must be observed.**



Caution

**When working on, or in the vicinity of, hydraulic systems, naked flames, spark generation and smoking are forbidden.**



Caution

**Hydraulic oils and water-polluting fluids must not be allowed to enter the soil or watercourses or sewer systems. Please ensure safe and environmentally friendly disposal of hydraulic oils. The relevant regulations in the country concerned with regard to ground water pollution, used oil and waste must be complied with.**



**Not suitable for cleaning with high-pressure cleaner!**

### Customer Information in respect of Machinery Directive 2006/42/EC

Hydraulic filters are fluid power parts/components and are therefore excluded from the scope of the Machinery Directive. They do not bear the CE mark.

Before using these components, ensure compliance with the specifications provided by HYDAC Filtertechnik GmbH in this documentation.

The specifications also contain information on the relevant essential health and safety requirements (based on Machinery Directive 2006/42/EC) that are to be applied by the user.

We hereby declare that the filters are intended to be incorporated into machinery within the terms of the Machinery Directive 2006/42/EC.

It is prohibited to put the filters into service until the machinery as a whole is in conformity with the provisions of the Machinery Directive. Furthermore, our Terms of Sale and Delivery are available on our website ([www.hydac.com](http://www.hydac.com)).

### SERVICE ADDRESSES

HYDAC Service GmbH  
Postfach 1251  
66273 Sulzbach / Saar, Germany

**Factory address:**  
Werk 13  
Friedrichsthaler Str. 15  
66540 Neunkirchen / Heinitz  
Germany

**ServiCenter:**  
Tel.: +49 (0) 6897 / 509-9083  
Fax: +49 (0) 6897 / 509-9881

**Customer service:**  
Tel: +49 (0) 6897 / 509-412  
Fax: +49 (0) 6897 / 509-828

### 5.2 MAINTENANCE, GENERAL

This section describes maintenance work which must be carried out periodically. The operational safety and life expectancy of the filter, and whether it is ready for use, depend to a large extent on regular and careful maintenance.

### 5.3 MAINTENANCE MEASURES

- Spare parts must fulfil the technical requirements specified by the manufacturer.  
This is always guaranteed for original HYDAC spare parts.
- Keep tools, working area and equipment clean.
- After disassembling the filter, clean all parts, check for damage or wear and replace parts if necessary.
- When changing a filter element, a high level of cleanliness must be observed!

### 5.4 INTERVAL BETWEEN ELEMENT CHANGES

The filter elements or filters must be replaced as frequently as the fluid filters, but at least every 12 months.

### NOTE

The information in this brochure relates to the operating conditions and applications described. For applications or operating conditions not described, please contact the relevant technical department. Subject to technical modifications.

This image shows a full page of blank graph paper. The grid consists of small, equal-sized squares formed by thin black lines. There are no margins, text, or other markings on the page.