

# ON-BOARD FUEL FILTRATION PRODUCTS

## HDP-HT Series

Heavy-Duty Diesel PreCare - Automatic Water Drain

14.5 psia • up to 476 gph

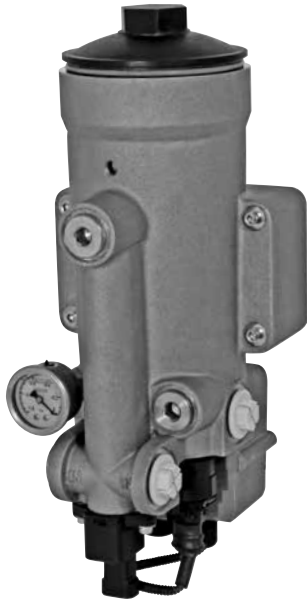

Model No. of filter in photograph is: HDP KF1 600 HT1 XX UED 1.1 /-AS1-H2

### Description

Mobile machines and commercial vehicles are subject to the toughest working conditions. To ensure smooth running of vehicles, and to protect both the engine and the drive system from damage, optimum diesel fuel conditioning is particularly important. HYDAC Fuel Filtration On-Board Diesel Coalescing filter offers a modern cartridge filter system design available in a fully automated water drain configuration, in order to minimize operator intervention and protect equipment from failures, breakdowns and expensive service interventions

### Features

- Fully Automatic water drain
- Optional fuel pre-heater and standard Water-In-Fuel (WIF) sensor
- Small envelope size offers greater flexibility in mounting locations
- Low investment cost due to the economical design
- Long service life of the element yields low operating costs
- Easy installation due to various porting configurations
- Easy adaption to the on-board power supply
- Unsurpassed water removal for ULSD

### Technical Specifications

Flow Rating:	up to 476 gph (up to 1800 lph)
Operating Pressure:	<14.5 psia, (<1 bar absolute) suction side application
Temperature Range:	HT: -4°F to 194°F (-20°C to 90°C) *for extended ranges, contact factory
Nominal Voltage:	24V DC (12V DC is optional for heater)
Rated Power Fuel Preheating:	300W
Weight of incl. Element:	600 HT: 9.4 lbs (4.25 kg) *other models available upon request
Water Separation Efficiency:	>95% to ISO CD 16332
Porting Thread:	600 HT: G 3/4" (BSPP)

# ON-BOARD FUEL FILTRATION PRODUCTS

<b>Model Code</b> <i>(also order example)</i>	<b>HDP</b>	<b>KF1</b>	<b>600</b>	<b>HT1</b>	<b>10</b>	<b>A</b>	<b>1</b>	<b>.</b>	<b>X</b>	<b>/</b>	<b>-AS1</b>
<b>Filter Series</b>	_____										
HDP = HYDAC Diesel PreCare											
<b>Filter Material</b>	_____										
KF1 = Dieselmicron®											
<b>Size</b>	_____										
600 = 160 gph (600 lph)											
1200 = 317 gph (1200 lph)											
1800 = 476 gph (1800 lph)											
<b>Evolution Stage</b>	_____										
HT1 = Auto Drain Configuration											
<b>Filtration Rating</b>	_____										
7 = 7 µm											
10 = 10 µm											
30 = 30 µm											
<b>Type of Clogging Indicator</b>	_____										
A = Blanking Plug In Indicator Port											
UED = Vacuum Gauge											
<b>Type Code</b>	_____										
1											
<b>Modification Number</b>	_____										
X = Latest version number always supplied											
<b>Options</b>	_____										
-AS1 = Water-In-Fuel Sensor (standard)											
-H1 = Fuel Pre-Heater (12 VDC)											
-H2 = Fuel Pre-Heater (24 VDC)											

Notes: For other options or configurations not listed, please contact factory

## Element Particulate Performance

Particulate Elements	Filtration Ratio Per ISO 19438 n > 10 µm (c)	Dirt Retention Per ISO 19438 to DP
10 µm	> 99%	300 mbar m > 42g

## Element Water Coalescing Performance

Coalescing Element	Suction Side Coalescing Per ISO CD 16332	
10 µm	Max Flow	Single Pass Water Removal Efficiency
	160 gal/h	> 95%

Flow Direction: Outside In  
 Element Nominal Dimensions: 3.8" (95.6 mm) O.D. x 7.0" (177.2 mm) long - 340 Size  
 3.8" (95.6 mm) O.D. x 9.4" (238.2 mm) long - 600 Size

Note: For additional HDP performance information, please contact the factory

## Fuel Oils

- ULSD15 and similar petroleum diesels
- Biodiesel blends
- Synthetic diesel and blends

Note: For Flow and Pressure information, please contact the factory

## Replacement Elements

Size	Evolution Stage	Filtration Rating	Filter Material
0600	HT1	007	KF1
		010	
		030	

# ON-BOARD FUEL FILTRATION PRODUCTS

## Dimensions HDP-HT 600

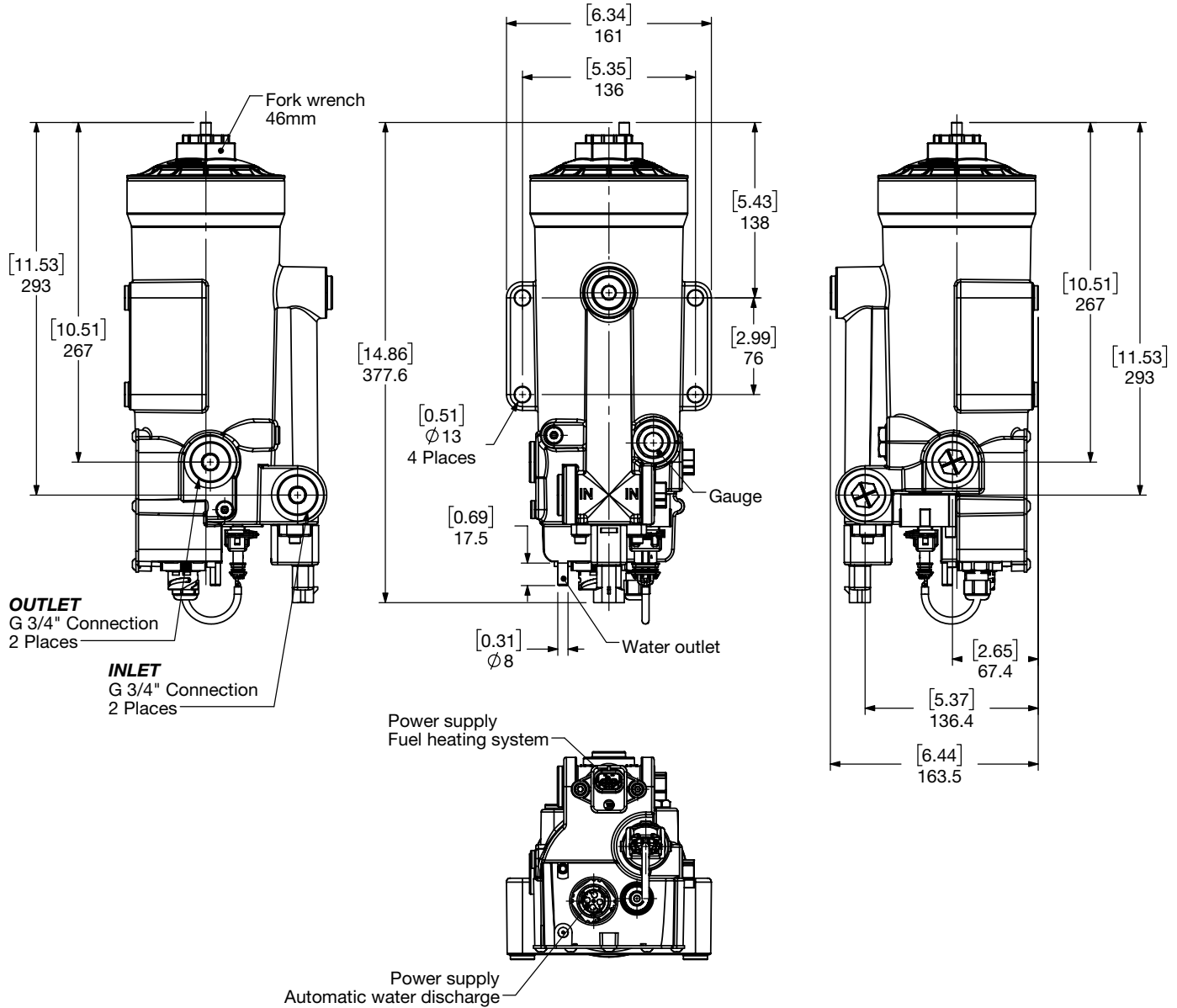
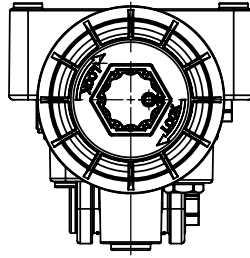

Dimensions shown are [inches] millimeters and for general information only. For complete dimensions please contact HYDAC to request a certified print.

HDP	600 HT	1200 HT	1800 HT
Weight incl. element lbs. (kg)	9.5 (4.3)	24.3 (11.0)	37.5 (17.0)

For drawing of configurations not shown, contact factory